

| REV | DESCRIPTION (ECO) | DATE | APPROVED |
|-----|----------------------------------------|----------|----------|
| D | ADD ISO80369-7 TO NOTES, ECO 8017 | 05/03/18 | AK |
| E | CORRECT TYPO ON BOM. SHEET 2. eco 8615 | 05/24/19 | AK |

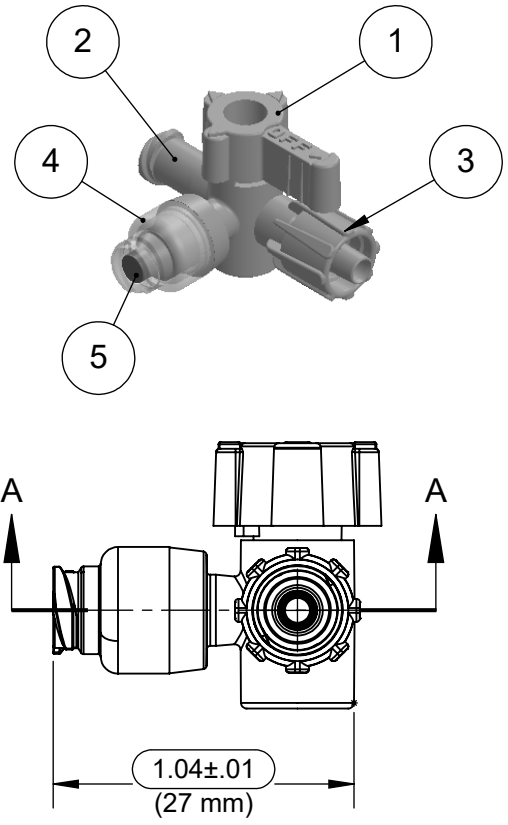
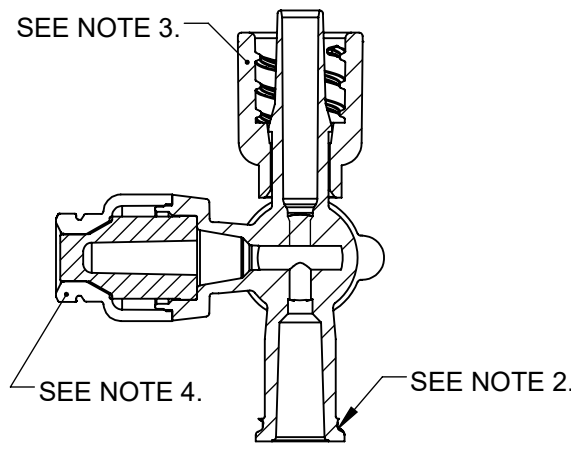
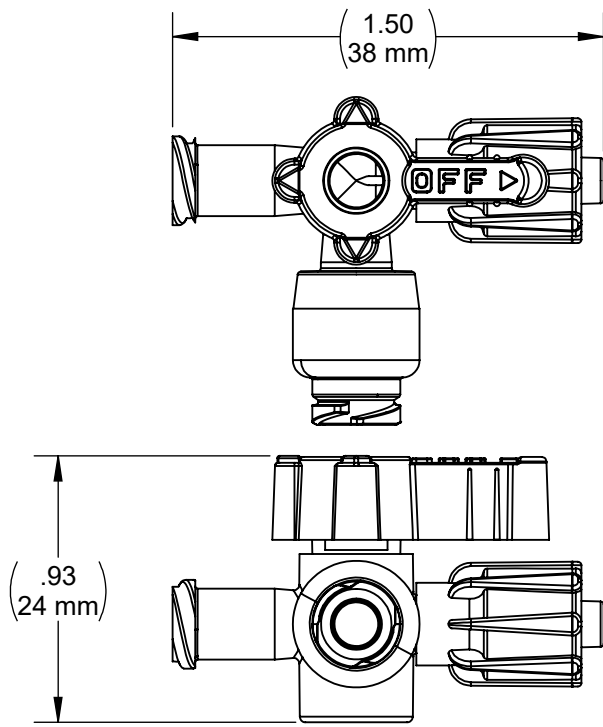

NOTES:

1. SUFFIX "X" INDICATES HANDLE COLOR: W - WHITE
2. FEMALE LUER CONFORMS WITH ISO594-2.
3. MALE LUER CONFORMS WITH ISO594-2.
4. SWABABLE FEMALE LUER COMPATIBLE WITH ISO594-2, AND ISO80369-7.
5. CRITICAL DIMENSIONS CIRCLED, AND SUBJECT TO INSPECTION.
6. DIMENSIONS IN PARENTHESES ARE FOR REFERENCE ONLY.
7. ALL DIMENSIONS ARE IN INCHES WITH NOMINAL IN METRIC BELOW.

QUALITY CRITERIA:

| |
|----------------------------------------------------------------------------------------------|
| O.D. FLASH: .020 MAX. (0.5mm) |
| GATE VESTIGE: .020 MAX. (0.5mm) |
| EMBEDDED PARTICLES, BUBBLES, SPOTS, STAINS: 0.3mm ² MAX. NO MORE THAN 3 PER PART. |

MOLDED PARTS:
GATES, PARTING LINES, AND FLASH PER QUALITY CRITERIA

PROPRIETARY AND CONFIDENTIAL
THE INFORMATION CONTAINED IN THIS DRAWING IS SOLE PROPERTY OF HALKEY-ROBERTS CORPORATION ST. PETERSBURG, FL. ANY REPRODUCTION IN PART OR AS A WHOLE WITHOUT THE WRITTEN PERMISSION OF HALKEY-ROBERTS CORPORATION IS PROHIBITED.

| | |
|--------------------------------------------------------------------------------------------------------------------------------------------------|----------------------------|
| DRAWN BY KJS | DATE 6/6/14 |
| APPROVED BY | DATE |
| MATERIAL | |
| FINISH | |
| UNLESS OTHERWISE SPECIFIED: DIMENSIONS ARE IN INCHES TOLERANCES: ANGULAR: ± 1° TWO PLACE DECIMAL ± .01 THREE PLACE DECIMAL ± .005 | THIRD ANGLE PROJECTION |

HR® Halkey-Roberts®

TITLE
4-WAY SWABABLE STOPCOCK ASSY. L HANDLE

SIZE
A

SCALE
2:1

DRAWING NO.
C245834024X

REV
E

DO NOT SCALE DRAWING

SHEET
1 OF 2